

HOUSING + STRAIGHT MALE JACK
CRIMP TYPE 5/50S CABLE PACK500

R197.134.D01

Series : **SMB**
CARLOCK

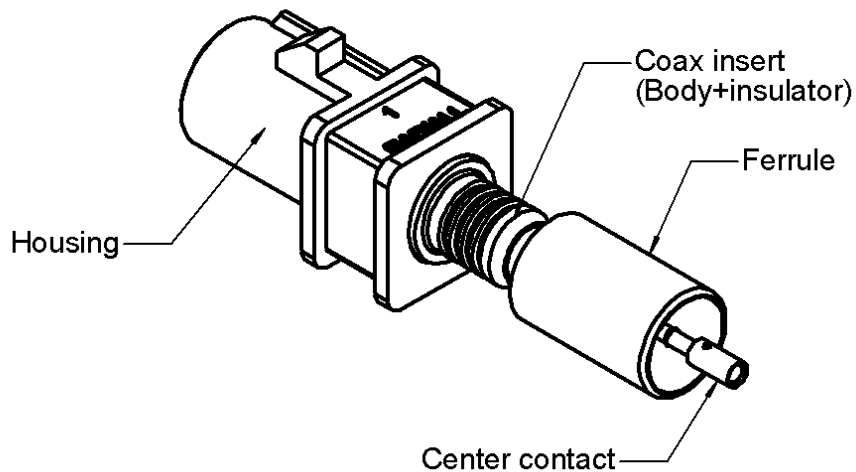
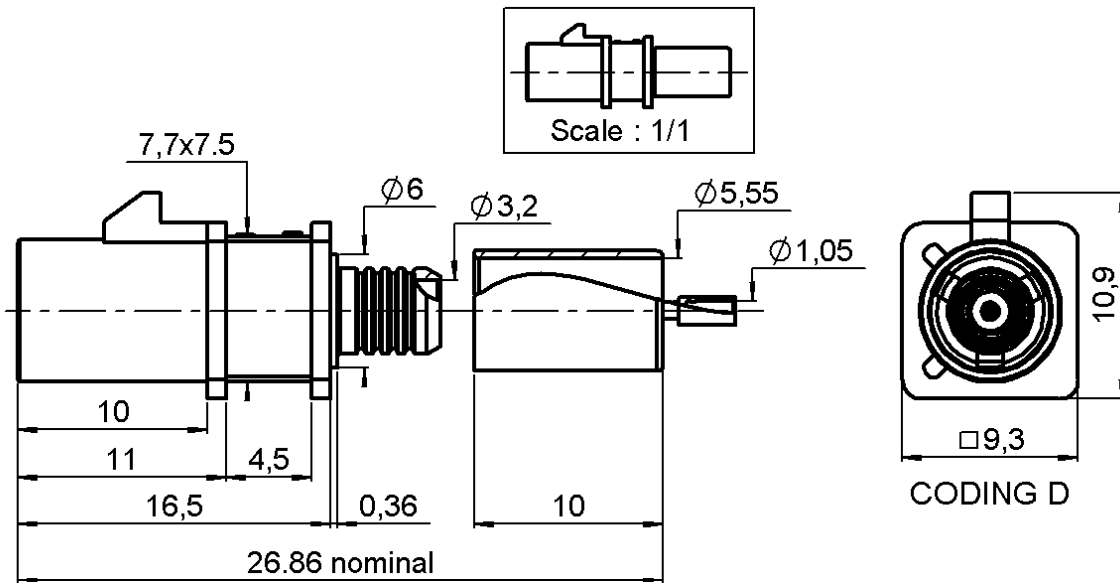

All dimensions are in mm.

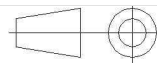

| COMPONENTS | MATERIALS | PLATINGS (µm) | |
|----------------|------------------------|------------------------|-----------------|
| BODY | BRASS | NICKEL 2 | |
| CENTER CONTACT | BRASS | GOLD 0.8 OVER NICKEL 2 | |
| OUTER CONTACT | - | - | |
| INSULATOR | PTFE | | |
| GASKET | - | | |
| OTHERS PARTS | BRASS | NICKEL 2 | |
| HOUSING | PA6.6 GF15 (POLYAMIDE) | UL CLASSIFICATION | COLOR |
| | | UL 94 V-2 | VIOLET RAL 4004 |

Issue : 0737 B

In the effort to improve our products, we reserve the right to make changes judged to be necessary.



HOUSING + STRAIGHT MALE JACK

CRIMP TYPE 5/50S CABLE PACK500

R197.134.D01

Series : **SMB**
CARLOCK

PACKAGING

| Standard | Unit | Other |
|------------|-------------------|-------------------|
| 500 | 'W' option | Contact us |

SPECIFICATION

SAE/USCAR-17 Rev.1 (October 2002)
SAE/USCAR-2 Rev.3 (February 2001)
SAE/USCAR-18 Rev.2 (January 2003)

ELECTRICAL CHARACTERISTICS

| | | |
|---------------------------------|------------------------|--------------------------|
| Impedance | 50 | Ω |
| Frequency | 0-4 | GHz |
| VSWR | 1.20** + 0,0000 | x F(GHz) Maxi |
| Insertion loss | 0.05 | \sqrt{F} (GHz) dB Maxi |
| RF leakage | -45 | - F(GHz)) dB Maxi |
| Voltage rating | 335 | Veff Maxi |
| Dielectric withstanding voltage | 1000 | Veff mini |
| Insulation resistance | 1000 | M Ω mini |

CABLE ASSEMBLY

| Stripping | a | b | c | d | e | f |
|-----------|------|------|------|------|------|------|
| mm | 2,40 | 5,50 | 10,2 | 0,00 | 7,80 | 0,00 |

Assembly instruction : **Page 3**

Recommended cable(s)
RG 58

MECHANICAL CHARACTERISTICS

| | | |
|----------------------------|-----------|-----------|
| Center contact retention | | |
| Axial force – Mating end | 10 | N mini |
| Axial force – Opposite end | 10 | N mini |
| Torque | NA | N.cm mini |

Characteristics indicated on this data sheet are those that can be achieved with the highest performance cable. Intrinsic limitations of the cable may diminish the performance of the assembly

Cable retention

| | | |
|------------|------------|--------|
| - pull off | 180 | N mini |
| - torque | | - N.cm |

TOOLING

| Part Number | Description | Hexagon |
|--------------|---------------------------------|-----------------|
| | | |
| R282.293.000 | CRIMPING TOOL M22520/5-01 | |
| R282.235.910 | CRIMPING DIES | Square 1.1 |
| R282.235.011 | CRIMPING DIES M22520/5-11 | 5.41 |
| R282.281.000 | CRIMPING TOOL | 2x4pts 7 pos |
| R282.967.034 | POSITIONER FOR TOOL R282 281 | |

| | | |
|--------------------|---------------|-------------|
| Recommended torque | | |
| Mating | NA | N.cm |
| Panel nut | NA | N.cm |
| Clamp nut | NA | N.cm |
| A/F clamp nut | 0,0000 | mm |
| Mating life | 100 | Cycles mini |
| Weight | 2,9500 | g |

ENVIRONMENTAL

| | | |
|-----------------------|------------------|--------------|
| Operating temperature | -40/+110* | $^{\circ}$ C |
| Hermetic seal | NA | Atm.cm3/s |
| Panel leakage | NA | |

OTHERS CHARACTERISTICS

* Depends on the cable used
** VSWR : 1.20 maxi at 4GHz

Issue : **0737 B**

In the effort to improve our products, we reserve the right to make changes judged to be necessary.



HOUSING + STRAIGHT MALE JACK
CRIMP TYPE 5/50S CABLE PACK500

R197.134.D01

Series : **SMB**
CARLOCK

Recommended mounting procedure for RG58 cable

COMPONENTS

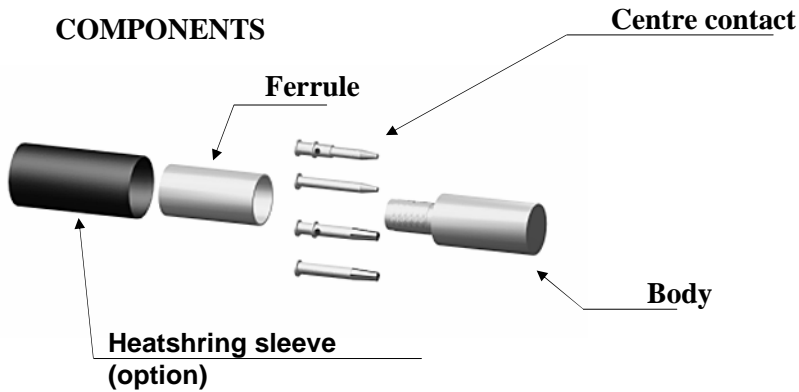

STRIPPING DIMENSIONS

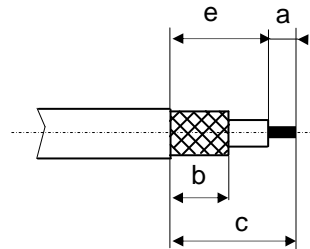

1

Slide the heatshrink sleeve onto the cable (Option).
 Slide the ferrule onto the cable.
 Strip the cable.



4

Slide the cable into the body until it bottoms against insulator.



2

Slide the centre contact on until it bottoms against the cable dielectric.
 Crimp the centre contact with crimping tool R282.235.910 (square 1.1) or with crimping tool R282.281.000 (7 position 2x4pts) + positioner R282.967.034.



5

Slide the ferrule over the braid.
 Crimp the ferrule with crimping tool R282.235.011 (Hex 5.41).

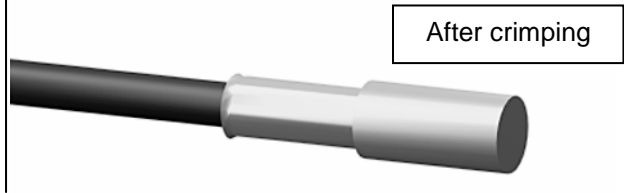

3

Fan the braid.

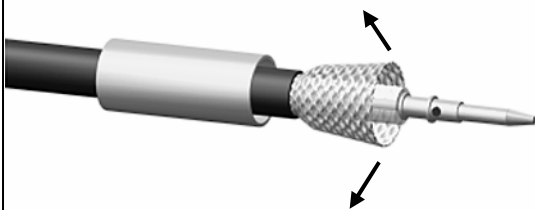

6

Check the position of the center contact between the top of the body and the top of the center contact : **0.56 ±0.20**.

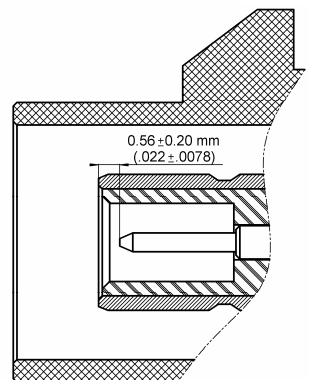

Issue : 0737 B

In the effort to improve our products, we reserve the right to make changes judged to be necessary.



RADIALL ®